

Size <b>A</b>	Part No.*	Across Flats <b>B</b> Max. Min.	Thickness <b>C</b> Max. Min.	Wrench Height Min.	Bearing Dia. Min.	Proof Load Min. N	Weight /1000 Lb.	Carton Qty.
M5x0.8	.5CFHN8#/3	8 7.78	4 3.7	2.96	6.8	11,500	2.71	14,000
M6x1	.6CFHN8#/3	10 9.78	5 4.7	3.76	8.8	16,300	5.51	7,000
M8x1.25	.8CFHN8#/3	13	6.5	4.91	11.3	30,400	11.5	3,400
M8x 1	.8FFHN8#/3	12.73	6.14			40,800		
M10x1.5	.10CFHN8#/3	17 16.73	8 7.64	6.11	15.3	48,100	25.6	1,500
M10x1.25	.10FFHN8#/3					63,600		
M10x1	.10XFHN8#/3					67,100		
M12x1.75	.12CFHN8#/3	19 18.67	10 9.64	7.71	17.2	70,800	38.1	1,000
M12x1.5	.12FFHN8#/3					92,500		
M12x1.25	.12XFHN8#/3					96,700		
M14x2	.14CFHN8#/3	22	11	8.24	20.2	96,000	55.1	700
M14x1.5	.14FFHN8#/3	21.67	10.3			131,200		
M16x2	.16CFHN8#/3	24	13	9.84	22.2	131,900	73.4	500
M16x1.5	.16FFHN8#/3	23.67	12.3			175,300		
M18x2.5	.18CFHN8#/3	27 26.16	15 14.3	11.44	25.3	176,600	109	350
M18x2	.18FFHN8#/3					210,100		
M18x1.5	.18XFHN8#/3					221,500		

\*Coating Codes (substitute for "#" in the part number). Other available finishes may not be listed.

[blank] – Unfinished Plain

- 1 – Zinc/Yellow per ASTM F1941 - Fe/Zn 5C
- 2 – Zinc/Clear per ASTM F1941 - Fe/Zn 5AT (RoHS)
- 3 – Cadmium/Clear per ASTM F1941 - Fe/Cd 5A
- 4 – Phosphate/Oil per ASTM F 1137 Grade D
- C – Commercial Cadmium/Clear
- Y – Commercial Zinc/Yellow
- Z – Commercial Zinc/Clear (RoHS)

M20 and larger see page 2

DIN 934 is superseded by ISO 4032, ISO 8673, and ISO 8674

**Notes:**

1. Dimensions per DIN 934 plus a locking feature
2. Threads as specified per DIN 13 part 12 and 15 prior to deflection
3. Prevailing torque and Material per DIN 267 part 15
4. Parts listed are not all stocked – contact Aztech sales for lead times
5. Latest specifications were used on the date of print release

## FULL HEX NUT DIN 934 CLASS 8



Date	By	Scale	Units	Type	Rev.
10-7-2014	SEK	None	mm	S	A

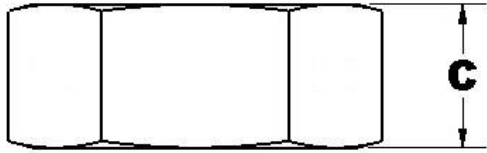
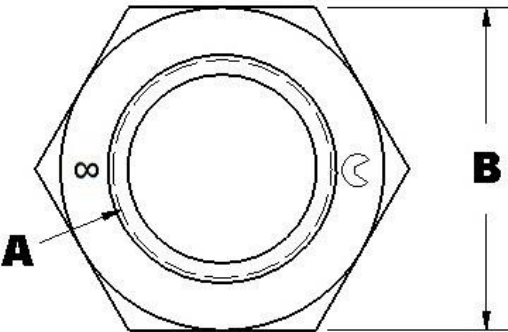
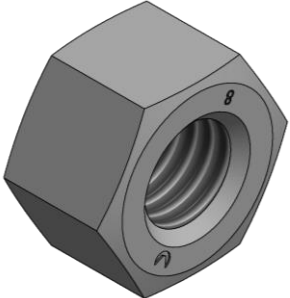

Size <b>A</b>	Part No.*	Across Flats <b>B</b> Max. Min.	Thickness <b>C</b> Max. Min.	Wrench Height Min.	Bearing Dia. Min.	Proof Load Min. N	Weight /1000 Lb.	Carton Qty.
M18 and smaller see page 1								
M20x2.5	.20CFHN8#/3	30 29.16	16 14.9	11.92	28.2	225,400	142	275
M20x2	.20FFHN8#/3					265,700		
M20x1.5	.20XFHN8#/3					280,200		
M22x2.5	.22CFHN8#/3	32 31	18 16.9	13.52	29.5	278,800	174	225
M22x2	.22FFHN8#/3					327,500		
M22x1.5	.22XFHN8#/3					343,000		
M24x3	.24CFHN8#/3	36 35	19 17.7	14.16	33.2	324,800	243	150
M24x2	.24FFHN8#/3					395,500		
M27x3	.27CFHN8#/3	41 40	22 20.7	16.56	38	422,300	364	100
M27x2	.27FFHN8#/3					510,900		
M30x3.5	.30CFHN8#/3	46 45	24 22.7	18.16	42.7	516,100	492	80
M30x2	.30FFHN8#/3					639,600		
M33x3.5	.33CFHN8#/3	50 49	26 24.7	19.76	46.6	638,500	635	60
M33x2	.33FFHN8#/3					783,800		
M36x4	.36CFHN8#/3	55 53.8	29 27.4	21.92	51.1	751,600	866	40
M36x3	.36FFHN8#/3					942,800		
M39x4	.39CFHN8#/3	60 58.8	31 29.4	23.52	55.9	897,900	1,110	35
M39x3	.39FFHN8#/3					1,123,000		

DIN 934 is superseded by ISO 4032, ISO 8673, and ISO 8674

\*Coating Codes (substitute for "#" in the part number). Other available finishes may not be listed.

- [blank] – Unfinished Plain
- 1 – Zinc/Yellow per ASTM F1941- Fe/Zn 5C
- 2 – Zinc/Clear per ASTM F1941 - Fe/Zn 5AT (RoHS)
- 3 – Cadmium/Clear per ASTM F1941 - Fe/Cd 5A
- 4 – Phosphate/Oil per ASTM F 1137 Grade D
- C – Commercial Cadmium/Clear
- Y – Commercial Zinc/Yellow
- Z – Commercial Zinc/Clear (RoHS)

- Notes:
1. Dimensions per DIN 934 plus a locking feature
  2. Threads as specified per DIN 13 part 12 and 15 prior to deflection
  3. Prevailing torque and Material per DIN 267 part 15
  4. Parts listed are not all stocked – contact Aztech sales for lead times
  5. Latest specifications were used on the date of print release

**FULL HEX NUT  
DIN 934 CLASS 8**

	Date	By	Scale	Units	Type	Rev.
	10-7-2014	SEK	None	mm	S	A