

Drawing No. CALN1

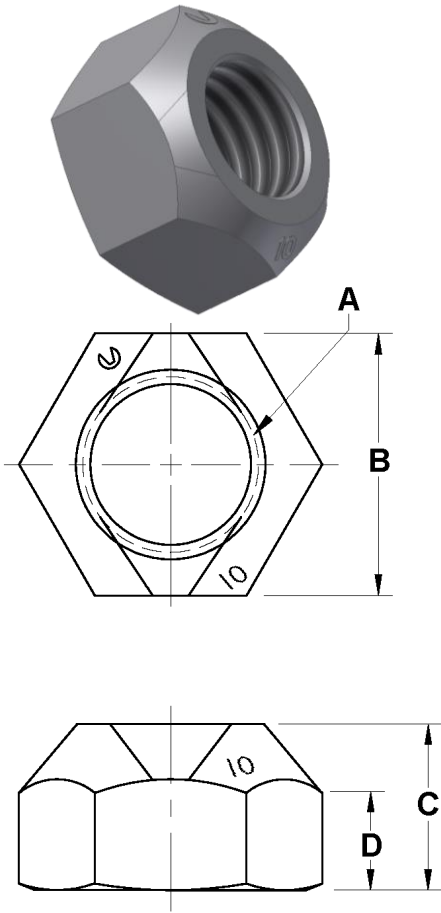

Size A	Part No.*	Across Flats B Max. Min.	Thickness C Max. Min.	Wrench Height D Min.	Bearing Dia. Min.	Proof Load Min. N	1 st Install Max. Nm	1 st Removal Min. Nm	5 th Removal Min. Nm	Weight /1000 Lb.	Carton Qty.
M5x0.8	.5CALN1#	8 7.78	5.3 4.8	2.7	6.9	14,800	2.1	0.35	0.24	3.60	11,000
M6x1	.6CALN1#	10 9.78	5.9 5.4	3	8.9	20,900	4	0.55	0.4	5.45	7,000
M8x1.25	.8CALN1#	13 12.73	7.1 6.44	3.7	11.6	38,100	8	1.15	0.8	9.68	4,000
M10x1.5*	.10CALN1#	15 14.73	9.7 8.7	5.6	13.6	60,300	14	2	1.4	17.6	2,000
M10x1.5	.10CALX1#	16 15.73	9 8.04	4.8	14.6	60,300	14	2	1.4	17.6	2,000
M12x1.75	.12CALN1#	18 17.73	11.6 10.37	6.7	16.6	88,500	21	3.1	2.1	30.6	1,300
M14x2	.14CALN1#	21 20.67	13.2 12.1	7.8	19.6	121,000	31	4.4	3	52.7	750
M16x2	.16CALN1#	24 23.67	16 14	8.8	22.5	165,000	42	6	4.2	79.0	500
M20x2.5	.20CALN1#	30 29.16	19 16.9	10.9	27.7	260,000	72	10.5	7	138	250
M24x3	.24CALN1#	36 35	23 20.2	13	33.2	374,000	106	15	10.5	316	125
M30x3.5	.30CALN1#	46 45	26.9 24.3	15.7	42.7	595,000	140	19	14	464	85
M36x4	.36CALN1#	55 53.8	32.5 29.4	19	51.1	866,000	180	24	17.5	607	65

*Coating Codes (substitute for "#" in the part number).
Other available finishes may not be listed.

[blank] – Unfinished Plain
1 – Zinc/Yellow per ASTM F1941 - Fe/Zn 5C
2 – Zinc/Clear per ASTM F1941 - Fe/Zn 5AT (RoHS)
3 – Cadmium/Clear per ASTM F1941 - Fe/Cd 5A
4 – Phosphate/Oil per ASTM F 1137 Grade D
C – Commercial Cadmium/Clear
Y – Commercial Zinc/Yellow
Z – Commercial Zinc/Clear (RoHS)

*M10 must be specifically requested as 15 mm width across flats to be quoted

Notes:

- These items are compliant to all requirements per ASME B18.16M
- Threads as specified per ASME B1.13M
- Parts listed are not all stocked – contact Aztech sales for lead times
- Latest specifications were used on the date of print release

AUTOMATION LOCKNUTS ASME B18.16M CLASS 10



Date	By	Scale	Units	Type	Rev.
9-15-2014	SEK	None	mm	S	A